

* RoHS COMPLIANT *

* REVISIONS				
LTR	DESCRIPTION	DATE	REVISED	APPROVED

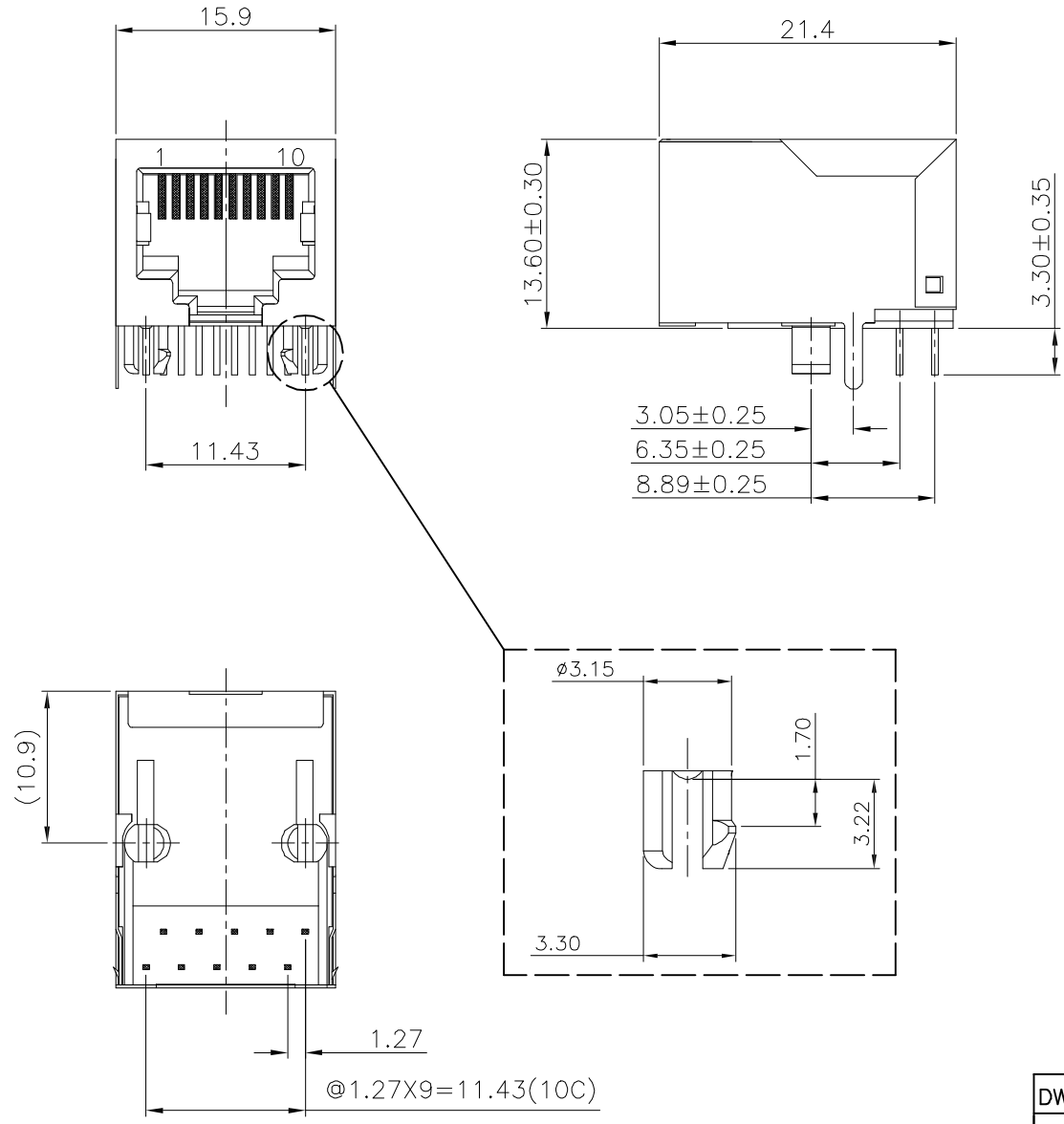

- NOTES:
- ELECTRICAL:**
- 1. VOLTAGE RATING : 125 VAC RMS.
 - 2. CURRENT RATING : 1.5 AMP.
 - 3. CONTACT RESISTANCE : 45 MILLIOHMS MAX.
 - 4. INSULATION RESISTANCE : 1000 MEGOHMS MIN @ 500 VDC.
 - 5. DIELECTRIC STRENGTH : 1000 VDC RMS 60Hz, 1MIN.
- MECHANICAL:**
- 1. HOUSING MATERIAL : PBT UL94V-0.
 - 2. CONTACT MATERIAL : PHOSPHOR BRONZE t=0.35mm
 - 3. CONTACT PLATING : GOLD PLATING OVER NICKEL.
 - 4. SHIELD PLATING : NICKEL PLATING OVER BRASS.
 - 5. OPERATING LIFE : 750 CYCLES MIN.
- ENVIRONMENTAL:**
- 1. STORAGE
 - 2. OPERATION: -40°C TO +85°C.
 - 3. WAVE SOLDERING TEMPERATURE: 230~240°C(3~5 SECONDS).
 - 4. RoHS COMPLIANT.
- MATES WITH MODULAR PLUG CONFORMING TO
FCC PART 68, SUBPART F.
CUL FILE NO. E345295

JCR-EL2911-9B03S14
4-30u"

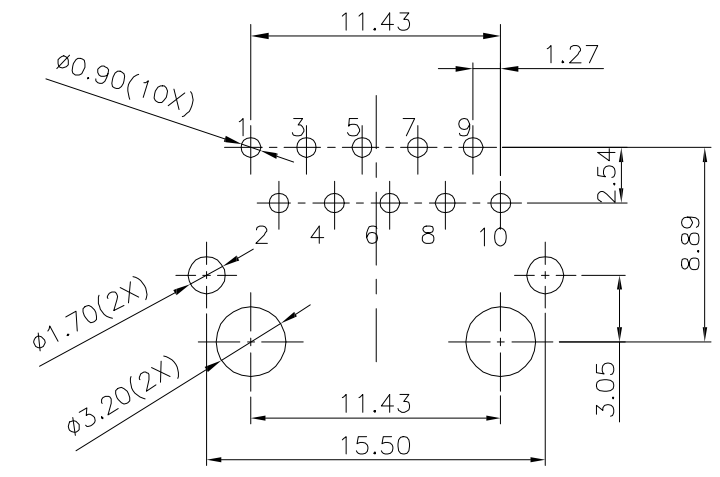

PC Board Layout Component Side Shown
PC Board Thickness=1.6mm PCB TOLERANCE:±0.05

UNLESS OTHERWISE SPECIFIED, TOLERANCE ON DECIMAL: ±0.3

DWN	LILY	DATE	2022.04.21	3RD ANGLE PROJECTION	NAME	RJ45 Tab down 10P10C
CHKD	ANDY	DATE	2022.04.21		CAT. NO.	JCR-EL2911-9B03S14
APVD	JON	DATE	2022.04.21	UNIT: mm	DWN.NO.	EX-EL2911-9B03S14
JKCR Electronics Co., Ltd.						001