

* RoHS COMPLIANT *

		* REVISIONS		
LTR	DESCRIPTION	DATE	REVISED	APPROVED

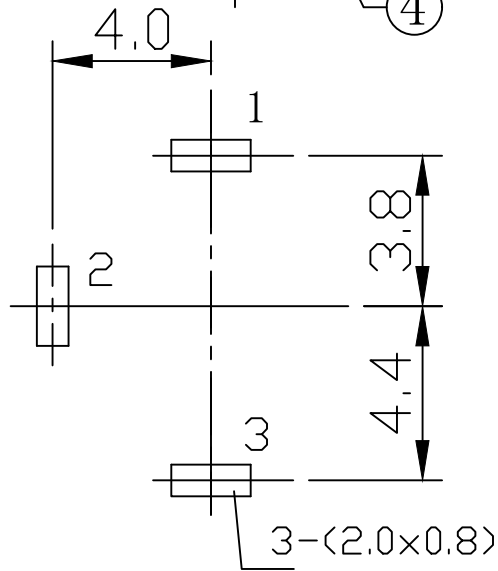
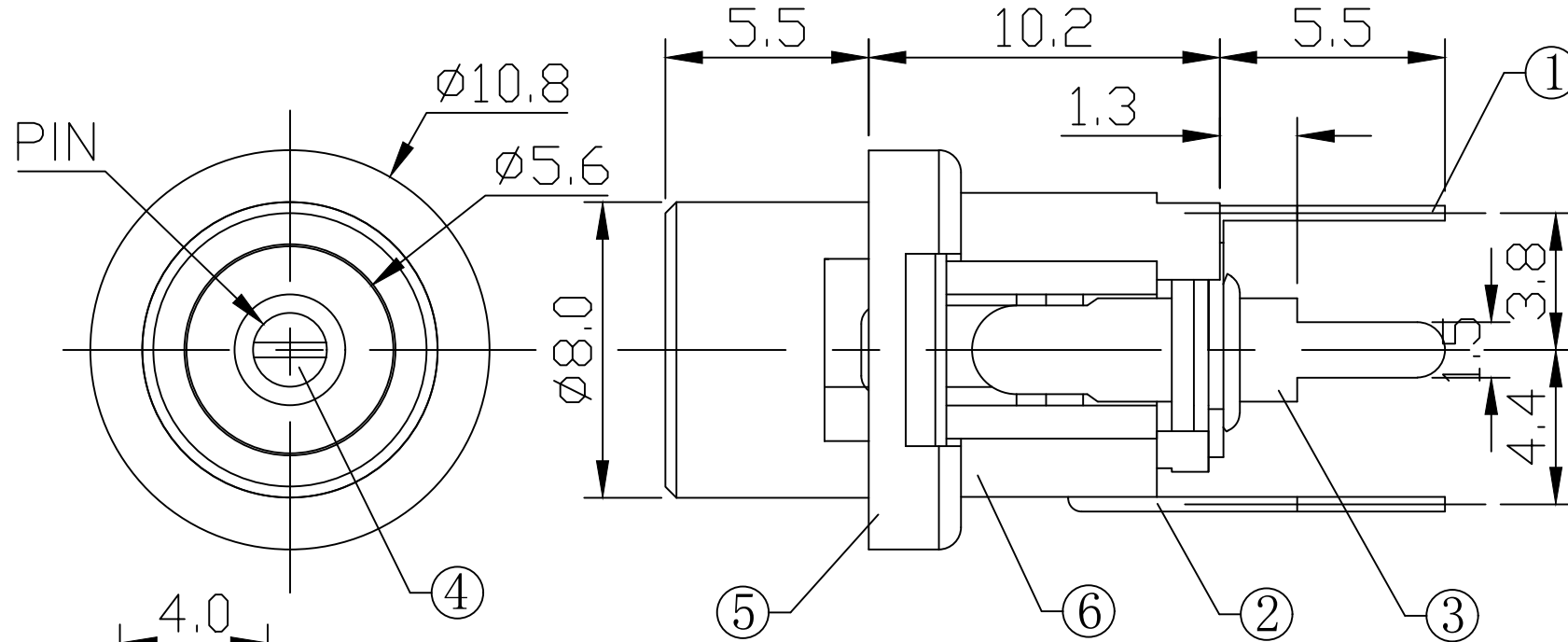

T:1.6 Dimensions of PC board holes
Tolerance : ± 0.05 (Printed-top view)

UNLESS OTHERWISE SPECIFIED, TOLERANCE ON DECIMAL: ± 0.3

CAT. NO.	PIN	SCHEMATIC
DCD-020-24A	$\phi 2.0$	1
DCD-020-24B	$\phi 2.5$	3 2

6	HOUSING	1	PBT 4815	UL-94V0
5	AXIS SUPPORT	1	COPPER ALLOY	Ni PLATED
4	PIN	1	COPPER ALLOY	Ni PLATED
3	SPRING	1	C5191	Sn PLATED
2	CURVE PIECE	1	C2680	Sn PLATED
1	FLAT PIECE	1	C2680	Sn PLATED
LTR	PART NAME	QTY	MATERIAL	REMARK
DWN	LILY	DATE	2014.12.25	3RD ANGLE PROJECTION NAME DC POWER JACK CAT. NO. DCD-020-24 DWN.NO. B-020-24
CHKD	ANDY	DATE	2014.12.25	
APVD	JON	DATE	2014.12.25	
JKCR Electronics Co., Ltd.				001